

* required information

Section 1 of 21

You can save the form at any time and resume it later. You do not need to be logged in when you resume.

- System reference This is the unique reference for this application generated by the system.
- Your reference You can put what you want here to help you track applications if you make lots of them. It is passed to the authority.
- Are you an agent acting on behalf of the applicant? Put "no" if you are applying on your own behalf or on behalf of a business you own or work for.
- Yes No

Applicant Details

- * First name
- * Family name
- * E-mail
- Main telephone number Include country code.
- Other telephone number
- Indicate here if the applicant would prefer not to be contacted by telephone

Is the applicant:

- Applying as a business or organisation, including as a sole trader
- Applying as an individual

A sole trader is a business owned by one person without any special legal structure. Applying as an individual means the applicant is applying so the applicant can be employed, or for some other personal reason, such as following a hobby.

Applicant Business

- Is the applicant's business registered in the UK with Companies House? Yes No Note: completing the Applicant Business section is optional in this form.
- Registration number
- Business name If the applicant's business is registered, use its registered name.
- VAT number Put "none" if the applicant is not registered for VAT.
- Legal status

Continued from previous page...

Applicant's position in the business

Home country

The country where the applicant's headquarters are.

Registered Address

Address registered with Companies House.

Building number or name

Street

District

City or town

County or administrative area

Postcode

Country

Agent Details

* First name

* Family name

* E-mail

Main telephone number

Include country code.

Other telephone number

Indicate here if you would prefer not to be contacted by telephone

Are you:

- An agent that is a business or organisation, including a sole trader
- A private individual acting as an agent

A sole trader is a business owned by one person without any special legal structure.

Agent Business

Is your business registered in the UK with Companies House? Yes No

Note: completing the Applicant Business section is optional in this form.

Registration number

Business name

If your business is registered, use its registered name.

VAT number

Put "none" if you are not registered for VAT.

Legal status

Continued from previous page...

Your position in the business

Home country

The country where the headquarters of your business is located.

Agent Registered Address

Address registered with Companies House.

Building number or name

Street

District

City or town

County or administrative area

Postcode

Country

Section 2 of 21

PREMISES DETAILS

I/we, as named in section 1, apply for a premises licence under section 17 of the Licensing Act 2003 for the premises described in section 2 below (the premises) and I/we are making this application to you as the relevant licensing authority in accordance with section 12 of the Licensing Act 2003.

Premises Address

Are you able to provide a postal address, OS map reference or description of the premises?

- Address OS map reference Description

Postal Address Of Premises

Building number or name

Street

District

City or town

County or administrative area

Postcode

Country

Further Details

Telephone number

Non-domestic rateable value of premises (£)

Section 3 of 21

APPLICATION DETAILS

In what capacity are you applying for the premises licence?

- An individual or individuals
- A limited company / limited liability partnership
- A partnership (other than limited liability)
- An unincorporated association
- Other (for example a statutory corporation)
- A recognised club
- A charity
- The proprietor of an educational establishment
- A health service body
- A person who is registered under part 2 of the Care Standards Act 2000 (c14) in respect of an independent hospital in Wales
- A person who is registered under Chapter 2 of Part 1 of the Health and Social Care Act 2008 in respect of the carrying on of a regulated activity (within the meaning of that Part) in an independent hospital in England
- The chief officer of police of a police force in England and Wales

Confirm The Following

- I am carrying on or proposing to carry on a business which involves the use of the premises for licensable activities
- I am making the application pursuant to a statutory function
- I am making the application pursuant to a function discharged by virtue of His Majesty's prerogative

Section 4 of 21

NON INDIVIDUAL APPLICANTS

Provide name and registered address of applicant in full. Where appropriate give any registered number. In the case of a partnership or other joint venture (other than a body corporate), give the name and address of each party concerned.

Non Individual Applicant's Name

Name

Details

Registered number (where applicable)

Description of applicant (for example partnership, company, unincorporated association etc)

Continued from previous page...

Company

Address

Building number or name

Street

District

City or town

County or administrative area

Postcode

Country

Contact Details

E-mail

Telephone number

Other telephone number

* Date of birth / /
dd mm yyyy

* Nationality [Documents that demonstrate entitlement to work in the UK](#)

Add another applicant

Section 5 of 21

OPERATING SCHEDULE

When do you want the premises licence to start? / /
dd mm yyyy

If you wish the licence to be valid only for a limited period, when do you want it to end / /
dd mm yyyy

Provide a general description of the premises

For example the type of premises, its general situation and layout and any other information which could be relevant to the licensing objectives. Where your application includes off-supplies of alcohol and you intend to provide a place for consumption of these off- supplies you must include a description of where the place will be and its proximity to the premises.

A petrol forecourt store located on Station Street, Ross On Wye, HR9 7YB, currently branded as Morrison's.

Continued from previous page...

If 5,000 or more people are expected to attend the premises at any one time, state the number expected to attend

Section 6 of 21

PROVISION OF PLAYS

[See guidance on regulated entertainment](#)

Will you be providing plays?

- Yes No

Section 7 of 21

PROVISION OF FILMS

[See guidance on regulated entertainment](#)

Will you be providing films?

- Yes No

Section 8 of 21

PROVISION OF INDOOR SPORTING EVENTS

[See guidance on regulated entertainment](#)

Will you be providing indoor sporting events?

- Yes No

Section 9 of 21

PROVISION OF BOXING OR WRESTLING ENTERTAINMENTS

[See guidance on regulated entertainment](#)

Will you be providing boxing or wrestling entertainments?

- Yes No

Section 10 of 21

PROVISION OF LIVE MUSIC

[See guidance on regulated entertainment](#)

Will you be providing live music?

- Yes No

Section 11 of 21

PROVISION OF RECORDED MUSIC

[See guidance on regulated entertainment](#)

Will you be providing recorded music?

- Yes No

Section 12 of 21

PROVISION OF PERFORMANCES OF DANCE

[See guidance on regulated entertainment](#)

Will you be providing performances of dance?

Continued from previous page...

Section 13 of 21

PROVISION OF ANYTHING OF A SIMILAR DESCRIPTION TO LIVE MUSIC, RECORDED MUSIC OR PERFORMANCES OF DANCE

[See guidance on regulated entertainment](#)

Will you be providing anything similar to live music, recorded music or performances of dance?

- Yes No

Section 14 of 21

LATE NIGHT REFRESHMENT

Will you be providing late night refreshment?

- Yes No

Standard Days And Timings

MONDAY

Start

End

Start

End

Give timings in 24 hour clock.
(e.g., 16:00) and only give details for the days
of the week when you intend the premises
to be used for the activity.

TUESDAY

Start

End

Start

End

WEDNESDAY

Start

End

Start

End

THURSDAY

Start

End

Start

End

FRIDAY

Start

End

Start

End

SATURDAY

Start

End

Start

End

SUNDAY

Start

End

Start

End

Continued from previous page...

Will the provision of late night refreshment take place indoors or outdoors or both?

- Indoors Outdoors Both

Where taking place in a building or other structure tick as appropriate. Indoors may include a tent.

State type of activity to be authorised, if not already stated, and give relevant further details, for example (but not exclusively) whether or not music will be amplified or unamplified.

The provision will take place inside the premises but customers may leave the premises with items purchased.

State any seasonal variations

For example (but not exclusively) where the activity will occur on additional days during the summer months.

Non-standard timings. Where the premises will be used for the supply of late night refreshments at different times from those listed in the column on the left, list below

For example (but not exclusively), where you wish the activity to go on longer on a particular day e.g. Christmas Eve.

Section 15 of 21

SUPPLY OF ALCOHOL

Will you be selling or supplying alcohol?

- Yes No

Standard Days And Timings

MONDAY

Start

End

Start

End

Give timings in 24 hour clock. (e.g., 16:00) and only give details for the days of the week when you intend the premises to be used for the activity.

TUESDAY

Start

End

Start

End

Continued from previous page...

WEDNESDAY

Start	<input type="text" value="06:00"/>	End	<input type="text" value="24:00"/>
Start	<input type="text"/>	End	<input type="text"/>

THURSDAY

Start	<input type="text" value="06:00"/>	End	<input type="text" value="24:00"/>
Start	<input type="text"/>	End	<input type="text"/>

FRIDAY

Start	<input type="text" value="06:00"/>	End	<input type="text" value="24:00"/>
Start	<input type="text"/>	End	<input type="text"/>

SATURDAY

Start	<input type="text" value="06:00"/>	End	<input type="text" value="24:00"/>
Start	<input type="text"/>	End	<input type="text"/>

SUNDAY

Start	<input type="text" value="06:00"/>	End	<input type="text" value="24:00"/>
Start	<input type="text"/>	End	<input type="text"/>

Will the sale of alcohol be for consumption:

- On the premises Off the premises Both

If the sale of alcohol is for consumption on the premises select on, if the sale of alcohol is for consumption away from the premises select off. If the sale of alcohol is for consumption on the premises and away from the premises select both.

State any seasonal variations

For example (but not exclusively) where the activity will occur on additional days during the summer months.

Non-standard timings. Where the premises will be used for the supply of alcohol at different times from those listed in the column on the left, list below

For example (but not exclusively), where you wish the activity to go on longer on a particular day e.g. Christmas Eve.

State the name and details of the individual whom you wish to specify on the licence as premises supervisor

Continued from previous page...

Name

First name

Family name

Date of birth

Enter the contact's address

Building number or name

Country

Personal Licence number (if known)

Issuing licensing authority (if known)

PROPOSED DESIGNATED PREMISES SUPERVISOR CONSENT

How will the consent form of the proposed designated premises supervisor be supplied to the authority?

- Electronically, by the proposed designated premises supervisor
- As an attachment to this application

Reference number for consent form (if known)

If the consent form is already submitted, ask the proposed designated premises supervisor for its 'system reference' or 'your reference'.

Section 16 of 21

ADULT ENTERTAINMENT

Highlight any adult entertainment or services, activities, or other entertainment or matters ancillary to the use of the premises that may give rise to concern in respect of children

Give information about anything intended to occur at the premises or ancillary to the use of the premises which may give rise to concern in respect of children, regardless of whether you intend children to have access to the premises, for example (but not exclusively) nudity or semi-nudity, films for restricted age groups etc gambling machines etc.

N/A

Continued from previous page...

Section 17 of 21

HOURS PREMISES ARE OPEN TO THE PUBLIC

Standard Days And Timings

MONDAY

Start

End

Start

End

Give timings in 24 hour clock.
(e.g., 16:00) and only give details for the days
of the week when you intend the premises
to be used for the activity.

TUESDAY

Start

End

Start

End

WEDNESDAY

Start

End

Start

End

THURSDAY

Start

End

Start

End

FRIDAY

Start

End

Start

End

SATURDAY

Start

End

Start

End

SUNDAY

Start

End

Start

End

State any seasonal variations

For example (but not exclusively) where the activity will occur on additional days during the summer months.

The opening hours of the store are not a licensable activity and the applicant asks that the hours not be restricted by the premises licence.

Non standard timings. Where you intend to use the premises to be open to the members and guests at different times from those listed in the column on the left, list below

For example (but not exclusively), where you wish the activity to go on longer on a particular day e.g. Christmas Eve.

Continued from previous page...

Section 18 of 21

LICENSING OBJECTIVES

Describe the steps you intend to take to promote the four licensing objectives:

a) General – all four licensing objectives (b,c,d,e)

List here steps you will take to promote all four licensing objectives together.

b) The prevention of crime and disorder

1. The premises shall install and maintain a comprehensive CCTV system as per the minimum requirements of the Police Licensing Team.
2. The CCTV system shall continually record whilst the premises is open for licensable activities and during all times when customers remain on the premises and will include the external area immediately outside the premises entrance.
3. All recordings shall be stored for a minimum period of 28 days with date and time stamping.
4. Viewing of recordings shall be made available subject to data protection legislation and as soon as is reasonably practicable upon the request of Police or authorised officer throughout the entire 28-day period.
5. A staff member from the premises who is conversant with the operation of the CCTV system shall be contactable at all times when the premises is open. This staff member must be able to provide a Police or authorised council officer copies of recent CCTV images or data with the absolute minimum of delay when requested.
6. An incident log shall be kept at the premises and made available on request to an authorised officer of the Council or the Police. It must be completed within 24 hours of the incident and will record the following:
 - a) all incidents of crime and disorder occurring at the premises all crimes reported to the premises
 - b) any incidents of disorder
 - c) any visit by a relevant authority or emergency service.

The log shall be retained at the premises or at the offices of the licence holder for a minimum period of 12 months.

7. There shall be no self-service of spirits except for spirit mixtures.

c) Public safety

There will at all times be adequate levels of staff maintained at the premises. Such staff levels will be disclosed, on request, to the licensing authority and police.

d) The prevention of public nuisance

Adequate waste receptacles for use by customers shall be provided in and immediately outside the premises.

Continued from previous page...

e) The protection of children from harm

1. The premises licence holder will ensure that an age verification policy will apply to the premises whereby all cashiers will be trained to ask any customer attempting to purchase alcohol, who appears to be under the age of 25 years (or older if the licence holder so elects) to produce, before being sold alcohol, identification being a passport or photocard driving licence bearing a holographic mark or other form or method of identification that complies with any mandatory condition that may apply to this licence.
2. All staff concerned in the sale or supply of alcohol shall undergo a recognised training scheme for such duties prior to the sale of alcohol by the staff member.
3. Refresher training must be completed and documented at intervals of no more than 6 months.
4. Training records will be retained at the premises or at the offices of the licence holder for a minimum period of 12 months from the date of training.
5. Signage informing customers of the age verification policy adopted at the premises will be prominently displayed at the point of sale and at any night pay window.
6. A written delegation of authority record will be kept at the premises whereby non personal licence holders are authorised to make sales on behalf of a personal licence holder.
7. A record shall be kept detailing all refused sales of alcohol. The record should include the date and time of the refused sale and the name of the member of staff who refused the sale. The record shall be available for inspection at the premises by the police or an authorised officer of the Council at all times whilst the premises is open. The record shall be retained at the premises or at the offices of the licence holder for a minimum period of 12 months.
8. All sales tills shall prompt the cashier making a sale of alcohol to verify that the customer is aged 18 or over.

Section 19 of 21

NOTES ON DEMONSTRATING ENTITLEMENT TO WORK IN THE UK

Continued from previous page...

If the document is not a passport, a copy of the whole document should be provided.

Your right to work will be checked as part of your licensing application and this could involve us checking your immigration status with the Home Office. We may otherwise share information with the Home Office. Your licence application will not be determined until you have complied with this guidance.

Home Office online right to work checking service

As an alternative to providing a copy of the documents listed above, applicants may demonstrate their right to work by allowing the licensing authority to carry out a check with the Home Office online right to work checking service.

To demonstrate their right to work via the Home Office online right to work checking service, applicants should include in this application their 9-digit share code (provided to them upon accessing the service at <https://www.gov.uk/prove-right-to-work>) which, along with the applicant's date of birth (provided within this application), will allow the licensing authority to carry out the check.

In order to establish the applicant's right to work, the check will need to indicate that the applicant is allowed to work in the United Kingdom and is not subject to a condition preventing them from doing work relating to the carrying on of a licensable activity.

An online check will not be possible in all circumstances because not all applicants will have an immigration status that can be checked online. The Home Office online right to work checking service sets out what information and/or documentation applicants will need in order to access the service. Applicants who are unable to obtain a share code from the service should submit copy documents as set out above.

Section 20 of 21

NOTES ON REGULATED ENTERTAINMENT

Continued from previous page...

- Dance: no licence is required for performances between 08.00 and 23.00 on any day, provided that the audience does not exceed 500. However, a performance which amounts to adult entertainment remains licensable.
- Cross activity exemptions: no licence is required between 08.00 and 23.00 on any day, with no limit on audience size for:
 - o any entertainment taking place on the premises of the local authority where the entertainment is provided by or on behalf of the local authority;
 - o any entertainment taking place on the hospital premises of the health care provider where the entertainment is provided by or on behalf of the health care provider;
 - o any entertainment taking place on the premises of the school where the entertainment is provided by or on behalf of the school proprietor; and
 - o any entertainment (excluding films and a boxing or wrestling entertainment) taking place at a travelling circus, provided that (a) it takes place within a moveable structure that accommodates the audience, and (b) that the travelling circus has not been located on the same site for more than 28 consecutive days.

Section 21 of 21

PAYMENT DETAILS

This fee must be paid to the authority. If you complete the application online, you must pay it by debit or credit card. Please visit the 'Premises Licence' webpage on Herefordshire Council's website (www.herefordshire.gov.uk) for the details of the application fee required

* Fee amount (£)

315.00

DECLARATION

* I/we understand it is an offence, liable on conviction to a fine up to level 5 on the standard scale, under section 158 of the licensing act 2003, to make a false statement in or in connection with this application.

[Applicable to individual applicants only, including those in a partnership which is not a limited liability partnership] I

* understand I am not entitled to be issued with a licence if I do not have the entitlement to live and work in the UK (or if I am subject to a condition preventing me from doing work relating to the carrying on of a licensable activity) and that my licence will become invalid if I cease to be entitled to live and work in the UK (please read guidance note 15).

* The DPS named in this application form is entitled to work in the UK (and is not subject to conditions preventing him or her from doing work relating to a licensable activity) and I have seen a copy of his or her proof of entitlement to work, if appropriate (please see note 15)

Ticking this box indicates you have read and understood the above declaration

This section should be completed by the applicant, unless you answered "Yes" to the question "Are you an agent acting on behalf of the applicant?"

* Full name

Winckworth Sherwood LLP

* Capacity

Agent

* Date

19 / 03 / 2024
dd mm yyyy

Add another signatory

Continued from previous page...

Once you're finished you need to do the following:

1. Save this form to your computer by clicking file/save as...
2. Go back to <https://www.gov.uk/apply-for-a-licence/premises-licence/herefordshire/apply-1> to upload this file and continue with your application.

Don't forget to make sure you have all your supporting documentation to hand.

IT IS AN OFFENCE LIABLE TO SUMMARY CONVICTION TO A FINE OF ANY AMOUNT UNDER SECTION 158 OF THE LICENSING ACT 2003, TO MAKE A FALSE STATEMENT IN OR IN CONNECTION WITH THIS APPLICATION

IT IS AN OFFENCE UNDER SECTION 24B OF THE IMMIGRATION ACT 1971 FOR A PERSON TO WORK WHEN THEY KNOW, OR HAVE REASONABLE CAUSE TO BELIEVE, THAT THEY ARE DISQUALIFIED FROM DOING SO BY REASON OF THEIR IMMIGRATION STATUS. THOSE WHO EMPLOY AN ADULT WITHOUT LEAVE OR WHO IS SUBJECT TO CONDITIONS AS TO EMPLOYMENT WILL BE LIABLE TO A CIVIL PENALTY UNDER SECTION 15 OF THE IMMIGRATION, ASYLUM AND NATIONALITY ACT 2006 AND PURSUANT TO SECTION 21 OF THE SAME ACT, WILL BE COMMITTING AN OFFENCE WHERE THEY DO SO IN THE KNOWLEDGE, OR WITH REASONABLE CAUSE TO BELIEVE, THAT THE EMPLOYEE IS DISQUALIFIED

OFFICE USE ONLY

Applicant reference number	<input type="text" value="TLV/39096/1129"/>
Fee paid	<input type="text"/>
Payment provider reference	<input type="text"/>
ELMS Payment Reference	<input type="text"/>
Payment status	<input type="text"/>
Payment authorisation code	<input type="text"/>
Payment authorisation date	<input type="text"/>
Date and time submitted	<input type="text"/>
Approval deadline	<input type="text"/>
Error message	<input type="text"/>
Is Digitally signed	<input type="checkbox"/>

[1](#) [2](#) [3](#) [4](#) [5](#) [6](#) [7](#) [8](#) [9](#) [10](#) [11](#) [12](#) [13](#) [14](#) [15](#) [16](#) [17](#) [18](#) [19](#) [20](#) [21](#) [Next >](#)

**CONSENT OF INDIVIDUAL TO BEING SPECIFIED AS
PREMISES SUPERVISOR**

I Paul Jones

Of

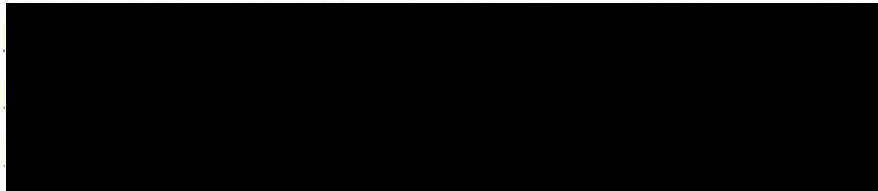

hereby confirm that I give my consent to be specified as the designated premises supervisor in relation to the application for a new premises licence by Motor Fuel Limited relating to a premises licence for

Ross On Wye Station St Service Station, Station Street, Ross On Wye, HR9 7YB

and any premises licence to be granted or varied in respect of this application made by Motor Fuel Limited concerning the supply of alcohol at

Ross On Wye Station St Service Station, Station Street, Ross On Wye, HR9 7YB

I also confirm that I am entitled to work in the United Kingdom and am applying for, intend to apply for or currently hold a personal licence, details of which I set out below.

Personal Licence No:

PA0300

Personal Licence Issuing Authority:

MERTHYR TYDFIL

Signed:

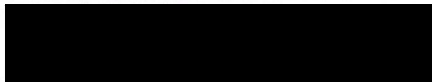

Name: Paul Jones

Dated:

30/01/2024

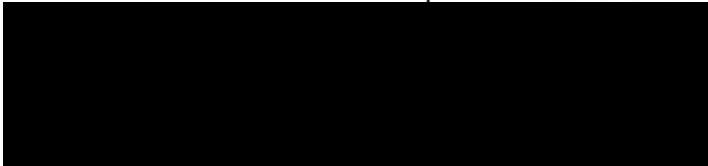

Nationality:

BRITISH

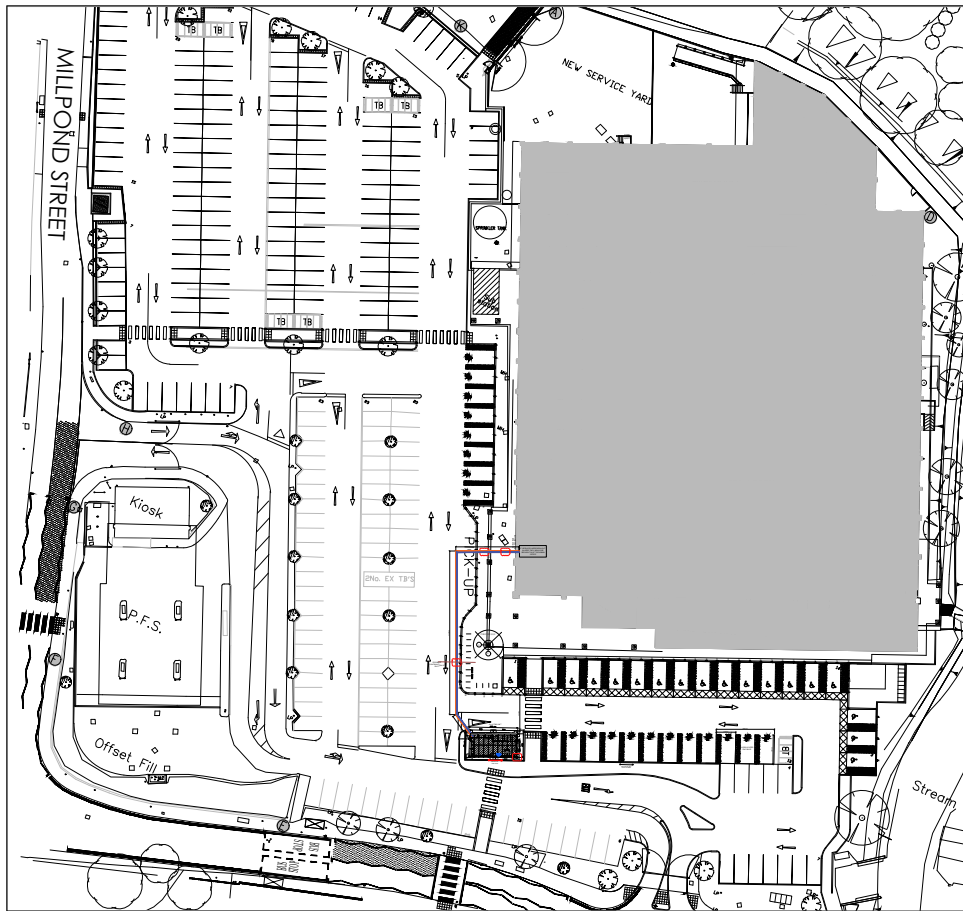

Site Plan Scale 1:1250

THE ENTIRE PREMISES MAY BE USED FOR THE SALE OF ALCOHOL AND THE PROVISION OF LATE NIGHT REFRESHMENT

Key - Drawing Information

[Symbol]	BOUNDARY OF PREMISES SALES FLOOR
----------	----------------------------------

Key - Fire Symbols

[Symbol]	NOTICE - 'FIRE DOOR-KEEP'
[Symbol]	NOTICE - 'KEEP LOCKED'
[Symbol]	ILLUMINATED EXIT DIRECTION
[Symbol]	EXIT SIGN
[Symbol]	EMERGENCY LIGHTING
[Symbol]	FIRE ALARM CALL POINT
[Symbol]	AUDIBLE WARNING
[Symbol]	SMOKE DETECTOR
[Symbol]	ALARM INDICATOR PANEL
[Symbol]	DOORS FITTED WITH PUSH BARS
[Symbol]	DOORS FITTED WITH PRESSURE RELEASE
[Symbol]	ROLLER SHUTTER DOOR
[Symbol]	FIRE EXTINGUISHER - WATER TYPE
[Symbol]	FIRE EXTINGUISHER - FOAM TYPE
[Symbol]	FIRE EXTINGUISHER - CARBON DIOXIDE
[Symbol]	FIRE EXTINGUISHER - DRY POWDER TYPE
[Symbol]	FIRE EXTINGUISHER - AQUEOUS SOLUTION
[Symbol]	FIRE EXTINGUISHER - VAPORISING LIQUID
[Symbol]	FIRE BLANKET
[Symbol]	FIRE HOSE REEL
[Symbol]	FIRE RESISTANT WALLS
[Symbol]	FIRE RESISTANT DOORS

ALL REQUIRED AREAS OF THE STORE ARE COVERED BY THE SPINKLER SYSTEM

NOTES:

1. FIRE FIGHTING EQUIPMENT & ALL OF THE REQUIREMENTS OF THE FIRE SERVICE WILL BE INCORPORATED & WILL BE PROVIDED TO COMPLY WITH THE EUROPEAN STANDARDS

No. BSEN3 & BS7863.

FIRE STANDARDS:

1. FIRE SAFETY RELATED SIGNS AND NOTICES ARE TO THE HEALTH AND SAFETY (SAFETY SIGNS & SIGNALS) REGULATIONS ACT 1996, THOSE THAT COMPLY TO BS 5499, PART 1, 1990 ALSO COMPLY
2. ILLUMINATED 'EXIT' SIGNS ARE TO CONFORM TO BS2560
3. FIRE FIGHTING EQUIPMENT IS TO COMPLY WITH EUROPEAN STANDARDS BS EN3 AND BS 7863

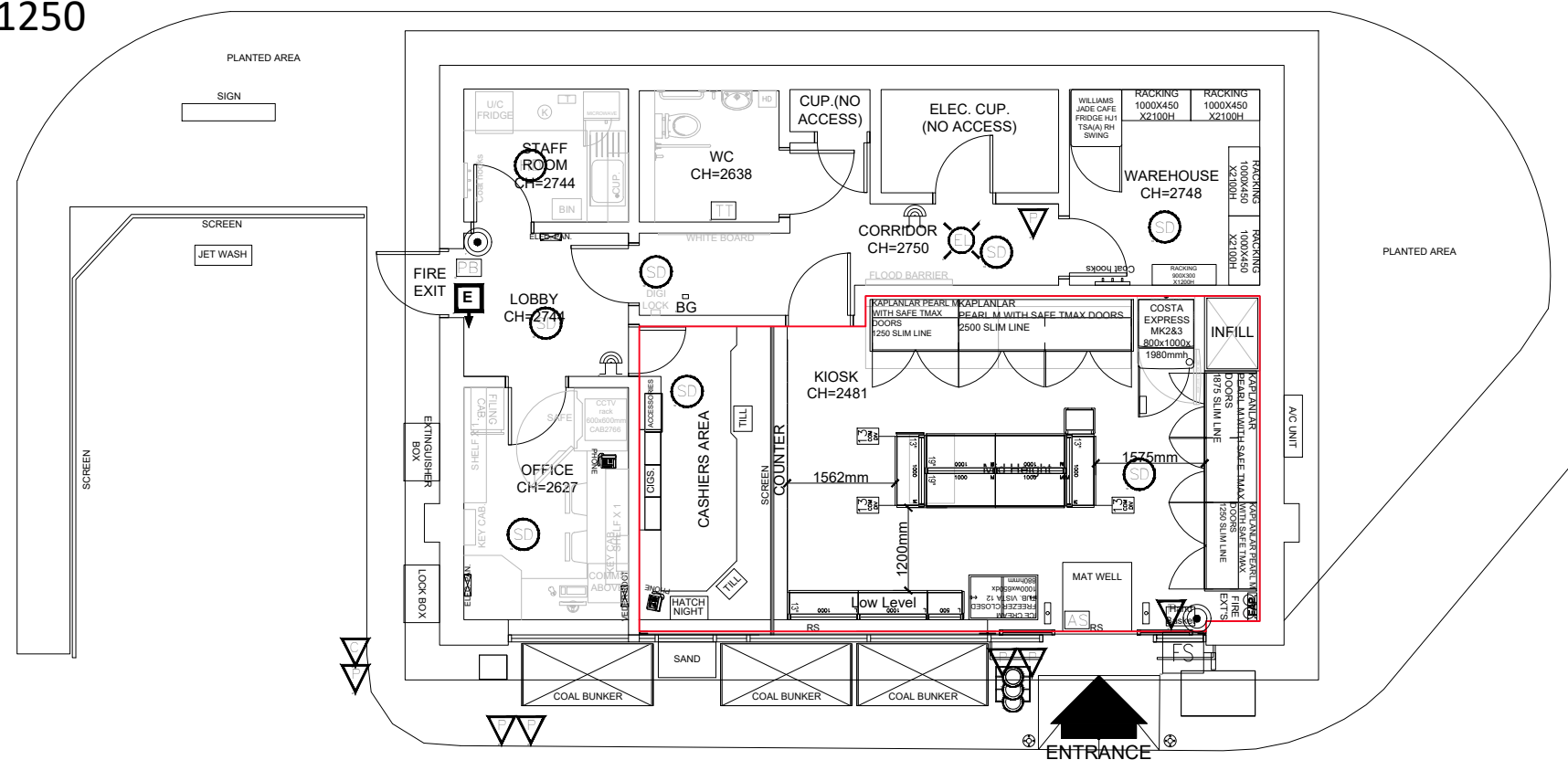

PFS

1258 Ross on Wye

Ross on Wye Station St HR9 7YB

SALES FLOOR

RETAIL SALES AREA 320 Sq. Ft.

Scale: 1:100

only scaled on A3

